

Escala 3 Circuit G12 Track fitting

Track Lighting



Data Sheet

Product Information

The Escala 3 circuit G12 HQI track fitting is ideal for commercial applications where you want to have a replaceable lamp. Supplied less lamp to give you the option of fitting your preferred lamp source.

They come complete with a 1 year warranty.

Product Features

- 1 year warranty
- Class I
- IP20
- 270° rotation and 180° tilt
- 18° Beam Angle
- Ceramic HQI Lamps Only
- Can be supplied in Black or White

Product Specification

Product Code	Product Description	Wattage (W)	Protection Class
KSR6426	Escala 35w G12 HQI Track fitting	35w Max	I
KSR6427	Escala 75w G12 HQI Track fitting	70w Max	I
Optional Accessory			
KSR6347	Escala 60° Reflector		

Technical Data	Escala 35w G12	Escala 70w G12
Nominal voltage	220~240VAC	220~240VAC
Operating frequency	50-60Hz	50-60Hz
Circuit Wattage	Max 35w HQI	Max 70w HQI
Circuit Current	0.35A	0.54A
Driver Current Rating	N/A	N/A
PFC	0.9	0.97
In Rush Current	1.7A Max Peak	1.7A Max Peak
Ambient temperature range	-10°C to +25°C	-10°C to +25°C
IP rating	20	20

Construction

Body: Cast Aluminium

Standards

BSEN60598-1:2021 Luminaires – Part 1: General requirements and tests

In Conformity with

LVD	Low voltage directive 2014/35/EU
EMC	Electromagnetic compatibility directive 2014/30/EU
ERP	Energy related products directive 2019/2020/EC
RoHS	Restriction of hazardous substances 2015/863/EU

Product Dimensions

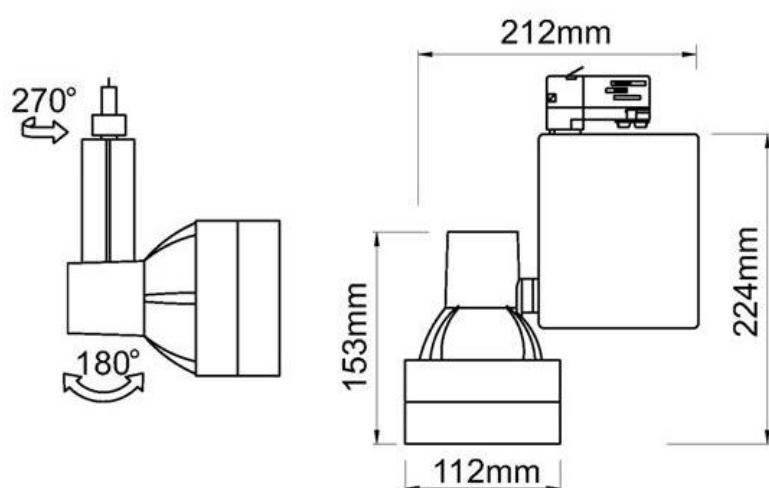

KSR Lighting is constantly developing and improving its products. For this reason, all product descriptions in this data sheet are intended as a general guide, and KSR may change specifications from time to time in the interest of product development, without prior notification or public announcement. All descriptions in this data sheet present only general particulars of the goods to which they refer and shall not form part of any contract. Data in this guide has been obtained in controlled experimental conditions. However, KSR Lighting cannot accept any liability arising from the reliance on such data to the extent permitted.