

Barro Spotlights

Residential Lighting



Data Sheet

Product Information

The Barro Spotlights are suitable for 50w GU10 lamps and are suitable for LED GU10 lamps. These fittings are available in 2 colours making them ideal for domestic and residential applications.

Product Features

- 1 year warranty
- Suitable for 50w GU10 lamps and LED GU10 lamps
- Class I
- 2 colour options: White and Polished Aluminium
- Dimmable dependant on lamp type used

KSR7250 Alu



KSR7251 Alu



Product Specification

Product Code	Product Description	Wattage (W)	CCT (K)	Lumens (lm)	Protection Class
KSR7250	Barro GU10 Single Spotlight	50w max	Varies	Varies	I
KSR7251	Barro GU10 Twin Spotlight	2x50w max	Varies	Varies	I

Nominal voltage	220~240VAC
Operating frequency	50Hz
Circuit Wattage	50w Max GU10 or GU10 LED
Circuit Current	Variable depending on lamp choice
Driver Current Rating	N/A
PFC	Variable depending on lamp choice
In Rush Current	Variable depending on lamp choice
Ambient temperature range	0°c to +30°c
IP rating	20

Construction

Body: Extruded Aluminium

Standards

BSEN60598-1:2015 Luminaires – Part 1: General requirements and tests

In Conformity with

LVD	Low voltage directive 2014/35/EU
EMC	Electromagnetic compatibility directive 2014/30/EU
ERP	Energy related products directive 2009/125/EC
RoHS	Restriction of hazardous substances 2011/65/EU

Product Dimensions

KSR7250

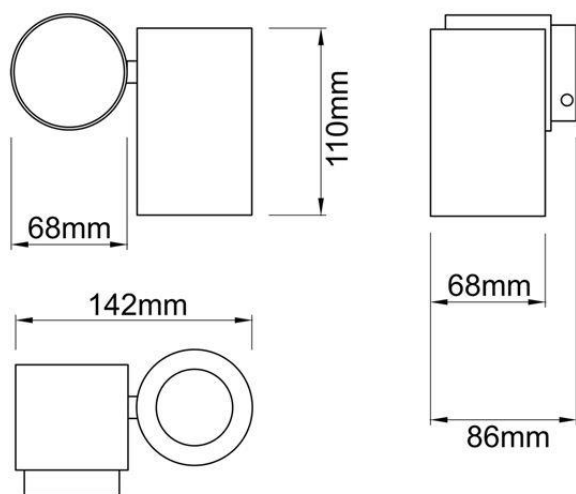

KSR7251

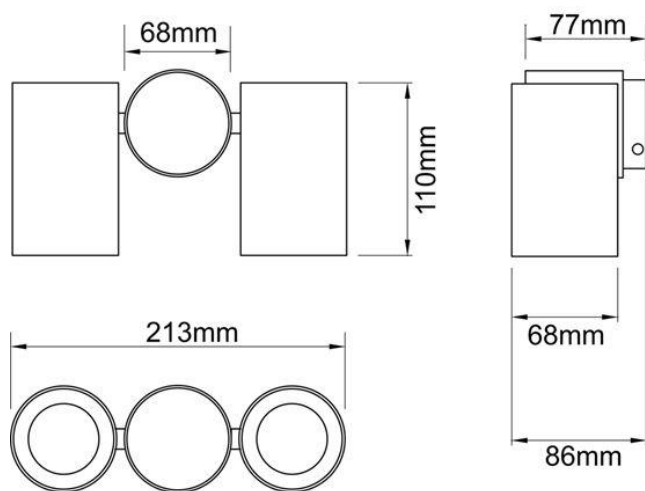

KSR Lighting is constantly developing and improving its products. For this reason, all product descriptions in this data sheet are intended as a general guide, and KSR may change specifications from time to time in the interest of product development, without prior notification or public announcement. All descriptions in this data sheet present only general particulars of the goods to which they refer and shall not form part of any contract. Data in this guide has been obtained in controlled experimental conditions. However, KSR Lighting cannot accept any liability arising from the reliance on such data to the extent permitted.