

Starlet CCT LED Flat Panel

Commercial Lighting

Data Sheet



Product Information

The 3 CCT Starlet Round Flat Panel LED downlights are a 3 in one solution for uses in commercial applications where the option to be able to adjust the colour to suit the application is required

This Range is available in four different outputs 6w, 12w, 18w and 20w.

Complete with a 3 year warranty

Product Features

- 3 year warranty
- IP44
- High CRI up to Ra87
- Instant on
- Optional Surface Mount Frame for 12w/18w/20w versions
- Life Expectancy up to 40,000hrs
- 3 switchable Colour temperatures 3000K/4000K/6000K
- Emergency Options available
- Supplied complete with driver
- Wide 112° beam angle

Product Specification

Product Code	Product Description	Wattage (W)	CCT (K)	Lumens (lm)	CRI (Ra)	Energy Efficiency Class	Protection Class
KSR9800	Starlet 6w CCT LED Flat Panel Downlight White	6	3000	313	82	A+	II
			4000	363	87		
			6000	324	84		
KSR9801	Starlet 12w CCT LED Flat Panel Downlight White	12	3000	823	84	A+	II
			4000	969	87		
			6000	898	84		
KSR9802	Starlet 18w CCT LED Flat Panel Downlight White	18	3000	1260	84	A+	II
			4000	1409	87		
			6000	1308	83		
KSR9803	Starlet 20w CCT LED Flat Panel Downlight White	20	3000	1385	84	A+	II
			4000	1556	87		
			6000	1433	84		

Accessories

KSR9805	Starlet 12w CCT Surface Frame
KSR9806	Starlet 18w CCT Surface Frame
KSR9807	Starlet 20w CCT Surface Frame

***for emergency options please add EM to the end of the part code**

Technical Data	Starlet CCT 6w	Starlet CCT 12w	Starlet CCT 18w	Starlet CCT 20w
Nominal voltage	100~240VAC	100~240VAC	100~240VAC	100~240VAC
Operating frequency	50-60Hz	50-60Hz	50-60Hz	50-60Hz
Circuit Wattage	5.9w including Driver	12w including driver	18.1w including driver	17.8w including driver
Circuit Current	0.05A	0.09A	0.14A	0.14A
Driver Current Rating	115mA	230mA	300mA	350mA
PFC	0.51	0.53	0.53	0.53
In Rush Current	0.11Amps Max Peak	0.26Amps Max Peak	0.31Amps Max Peak	0.35Amps Max Peak
Start Time	< 0.5 Sec	< 0.5 Sec	< 0.5 Sec	< 0.5 Sec
Ambient temperature range	-10°C to +30°C	-10°C to +30°C	-10°C to +30°C	-10°C to +30°C
IP rating	44	44	44	44

Construction

Body:	Aluminium
Lens:	Polystyrene (PS)
Surface Kit:	Polycarbonate

Standards

BSEN60598-1:2015	Luminaires – Part 1: General Requirements and tests
BSEN60598-2-22:2014	Luminaires – Part 2: Luminaires for Emergency Lighting

In Conformity with

LVD	Low voltage directive 2014/35/EU
EMC	Electromagnetic compatibility directive 2014/30/EU
ERP	Energy related products directive 2009/125/EC
RoHS	Restriction of hazardous substances 2011/65/EU

Product Dimensions

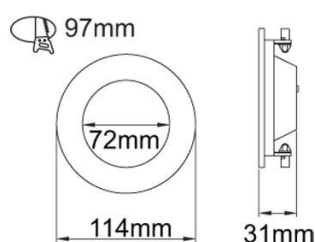

KSR9800

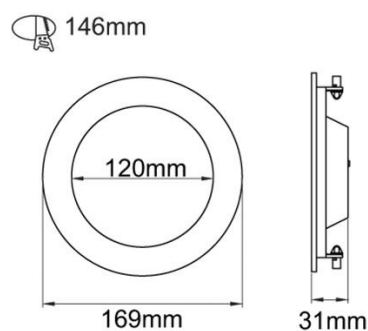

KSR9801

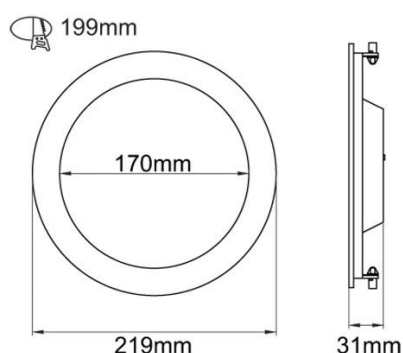

KSR9802

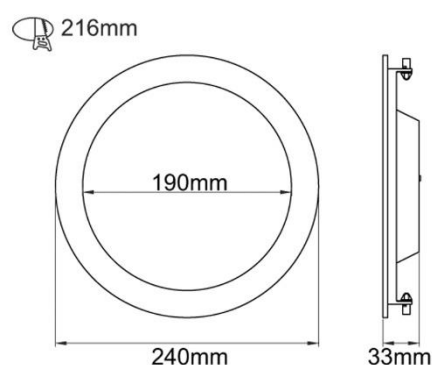

KSR9803

Surface Frames

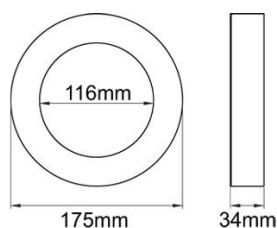

KSR9805

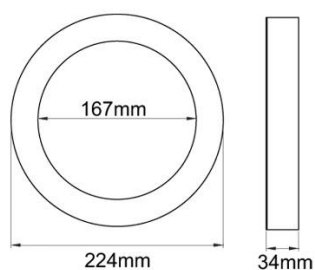

KSR9806

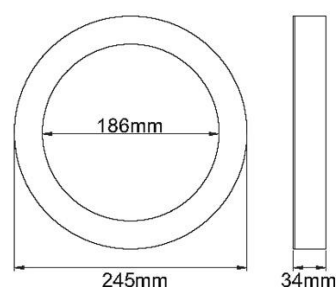

KSR9807

KSR Lighting is constantly developing and improving its products. For this reason, all product descriptions in this data sheet are intended as a general guide, and KSR may change specifications from time to time in the interest of product development, without prior notification or public announcement. All descriptions in this data sheet present only general particulars of the goods to which they refer and shall not form part of any contract. Data in this guide has been obtained in controlled experimental conditions. However, KSR Lighting cannot accept any liability arising from the reliance on such data to the extent permitted.