

# Navara HBX Multi Wattage High Bays



Data Sheet

## Product Information

The Navara HBX **Multi Wattage IP65 High Bay** range are suitable for a multitude of Industrial and commercial applications. Complemented by the optional **Remote** controlled Programmable **plug in Microwave** sensor this product provides an effective energy saving solution with high efficiency LED technology.

They come complete with a 5 year warranty for your peace of mind.

### KSR98201 with KSR98203



## Product Features

- 5 year warranty
- Class I
- IP65
- IK10
- 4000K LED
- Multi Wattage - 3 Sizes to cover 9 Outputs 60W, 80W & 100W, 90W, 120W & 150W or 120W, 160W & 200W
- Up to 28660 Lumens
- High efficiency CREE LED Chip up to **150 Lumens per Circuit Watt**
- CRI: >Ra84
- Optional 1-10V remote programmable plug in Microwave sensor
- 1-10V, Dali & Emergency Options available
- 90° Beam Angle
- Supplied with Eye hook suitable for jack chain/carabiner clip
- Optional surface mount Bracket
- L70 – 46,000hrs

# Product Specification

Product Code	Product Description	Wattage (W)	CCT (K)	Lumens (lm)	CRI (Ra)	Energy Efficiency Class	Protection Class
KSR98200	Navara HBX Multi Wattage 60W, 80W & 100W IP65 LED High Bay Black	60W	4000	9015lm	84	D	I
		80W	4000	10765lm	84	D	I
		100W	4000	14405lm	84	D	I
KSR98201	Navara HBX Multi Wattage 90W, 120W & 150W IP65 LED High Bay Black	90W	4000	12955lm	84	D	I
		120W	4000	16965lm	84	D	I
		150W	4000	21320lm	84	D	I
KSR98202	Navara HBX Multi Wattage 120W, 160W & 200W IP65 LED High Bay Black	120W	4000	16575lm	83	D	I
		160W	4000	22555lm	83	D	I
		200W	4000	28660lm	83	D	I
Mounting Accessories							
KSR98208	Navara HBX 100W Surface Mounting Bracket						
KSR98209	Navara HBX 150W Surface Mounting Bracket						
KSR98210	Navara HBX 200W Surface Mounting Bracket						

# Control Accessories

Product Code	Product Description	Operating Voltage	Detection Range	Recommended Mounting Heights	Time Delay	Lux Settings	Protection Class
KSR98203	Navara HBX Microwave Sensor	12VDC	4-10m (radius), Programmable	4-15m	2sec-10min	<2-50lux	III
KSR98204	Navara HBX Remote control programmer						
KSR98207	Navara HBX DALI Converter (Done in House)						

# Emergency Options

Product Code	Product Description
KSR98205	Navara HBX Maintained Emergency Pack
KSR98206	Navara HBX Self-Test Emergency Pack

# Technical Information

Technical Data	Navara V2 HBX Multi Wattage 60/80/100W IP65 LED			Navara V2 HBX Multi Wattage 90/120/150W IP65 LED			Navara V2 HBX Multi Wattage 120/160/200W IP65 LED		
Nominal voltage	200~240VAC			200~240VAC			200~240VAC		
Operating frequency	50-60Hz			50-60Hz			50-60Hz		
Wattage Selection	60W	80W	100W	90W	120W	150W	120W	160W	200W
Circuit Wattage (Including driver Losses)	59.62W	71.25W	95.49W	85.01W	116W	136W	109W	148.5W	179.3W
Circuit Current	0.26A	0.34A	0.42A	0.4A	0.53A	0.61A	0.51A	0.68A	0.84A
Efficiency (lm/W)	134.5	135.7	142.8	135.8	134.8	154.8	135.4	135.8	146.1
PFC	0.89	0.93	0.955	0.934	0.959	0.975	0.935	0.96	0.982
In Rush Current	80 Amps			80 Amps			80 Amps		
Start Time	0.35 Secs			0.35 Secs			0.35 Secs		
Beam Angle	90Deg			90Deg			90Deg		
Ambient temperature range	-5°c to +35°c			-5°c to +35°c			-5°c to +35°c		
IP rating	65			65			65		

## Construction

Body: Die Cast Aluminium  
 Lens: Polycarbonate

## Product Dimensions

**KSR98200**

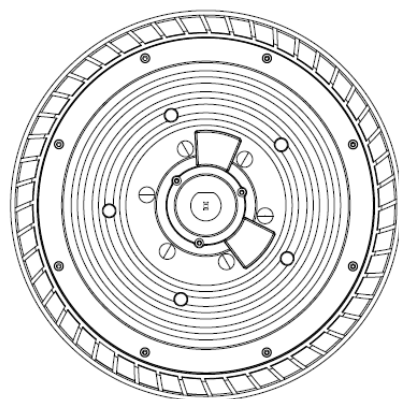
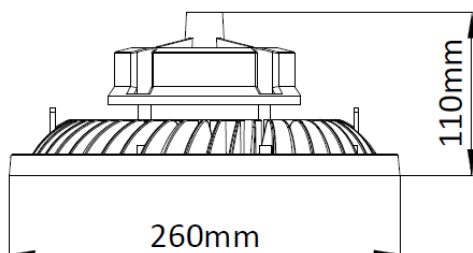

**KSR98201**

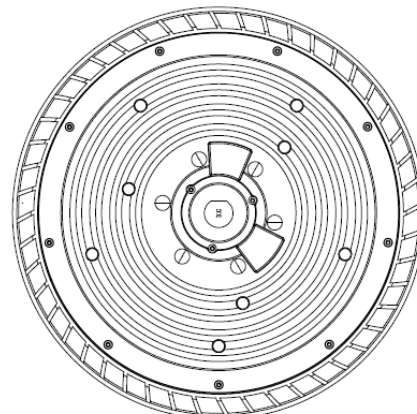
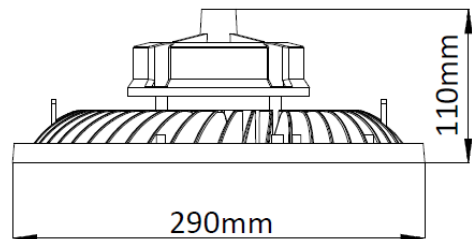

## KSR98202

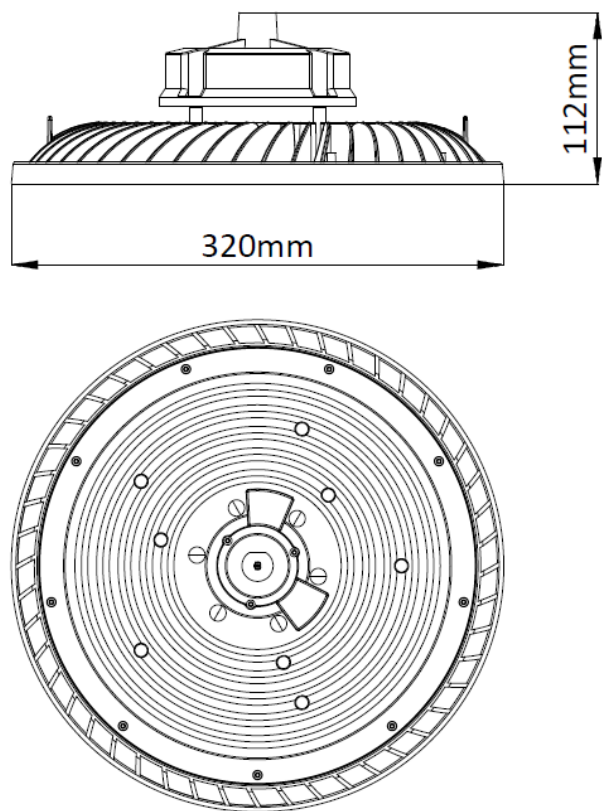

## KSR98203

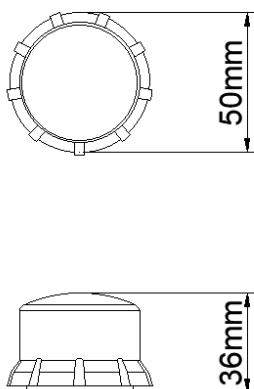

## KSR98207

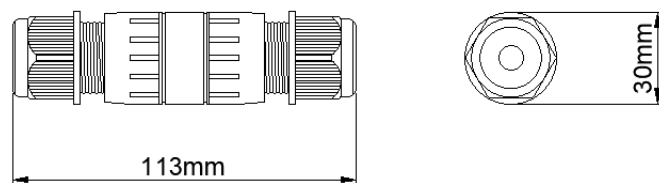

## KSR98208

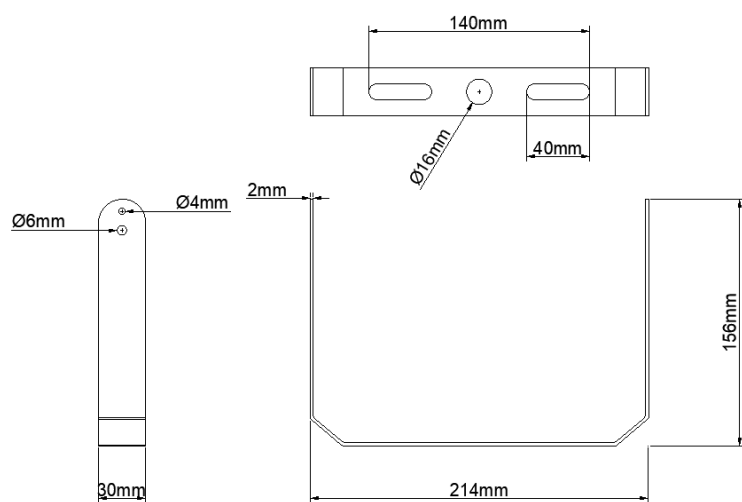

## KSR98209

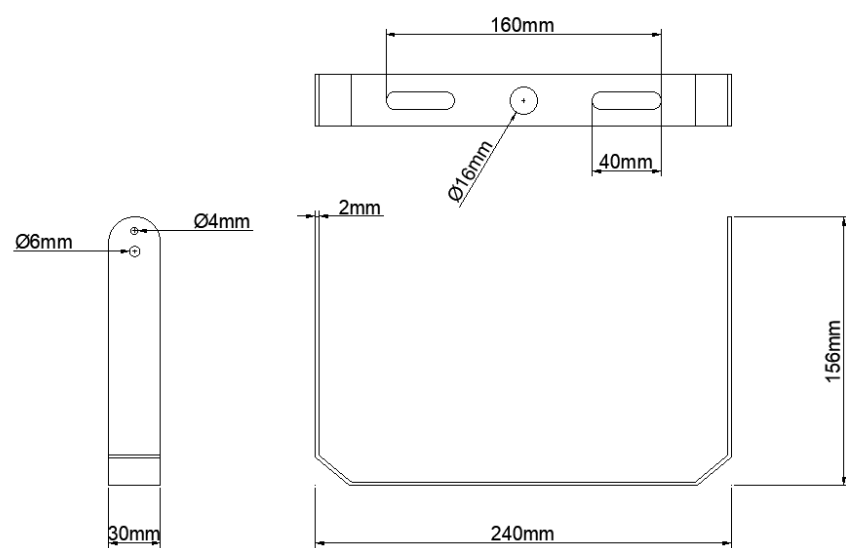

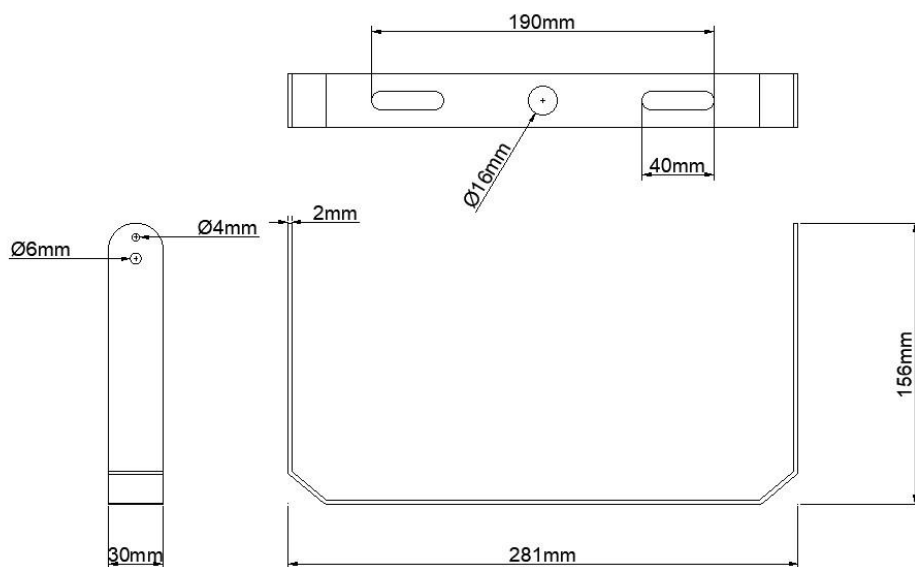

KSR Lighting is constantly developing and improving its products. For this reason, all product descriptions in this data sheet are intended as a general guide, and KSR may change specifications from time to time in the interest of product development, without prior notification or public announcement. All descriptions in this data sheet present only general particulars of the goods to which they refer and shall not form part of any contract. Data in this guide has been obtained in controlled experimental conditions. However, KSR Lighting cannot accept any liability arising from the reliance on such data to the extent permitted.