



Available finishes: Anthracite Only

KSR1922 - Can be mounted Vertically or Horizontally

Read these instructions before commencing installation. Please give these instructions to the owner/occupier after installation to retain for future reference/maintenance.

IP54 240V~50Hz 9W

These fittings are Class I and must be Earthed

Important Information

It is recommended that these luminaires are installed and fitted by a qualified electrician ensuring the installation complies with current IEE wiring regulations & local building control. These products are designed for connection to a 240V~50Hz supply. Any faulty, broken or damaged luminaires should be replaced immediately. KSR will not accept responsibility for any claims arising from a poor installation. Please Note: The limited warranty shall be deemed null and void in the following circumstances: Failure by the installer, end user or any third party to exercise caution to protect any covered product or part from outside damage, adverse temperature, humidity conditions, fluctuations in the electrical system or physical abuse as well as failure related to workmanship in the installation of the products or parts.

Important User Advice

Always switch off mains supply before installing/servicing. Do not use Megger or similar high voltage instruments. Due to the fact this product contains electronic components that may be damaged by high test voltages, they must be disconnected from the circuit before testing. To prevent damage to the driver, do not mix with conventional magnetic ballasts on the same electrical circuit. KSR recommends a maintenance schedule of washing down with soapy water (no abrasive cleaners) and greasing all screws every 3 months. At the end of life the luminaire is classed as WEEE under directive 2014/30/EU and should be disposed of in accordance with local legislation

Installation Procedure

Loosen the 2 side allen bolts and separate the backplate from the fitting (still joined via the earth cable). Fix the back plate to wall / surface using suitable fixings for the substrate, this fitting can be mounted either vertically or horizontally. Connect the relevant supply cable for outdoor use to the terminal block : Brown (Live) - Green / Yellow (Earth) & Blue (Neutral) as per Fig.1. ensuring the earth tag is still properly connected from the main body to the backplate. Offer the main body to the backplate and re-secure in place using the allen bolts loosened in the first stage. Ensure there are no trapped cables and the backplate and main body are connected together properly. Set the diffuser to the desired angle. Switch on the mains supply and test.

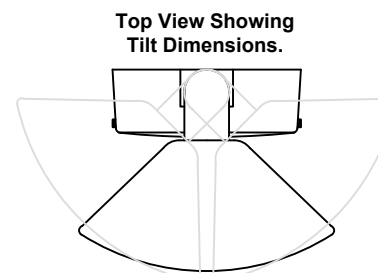
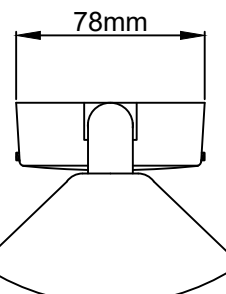
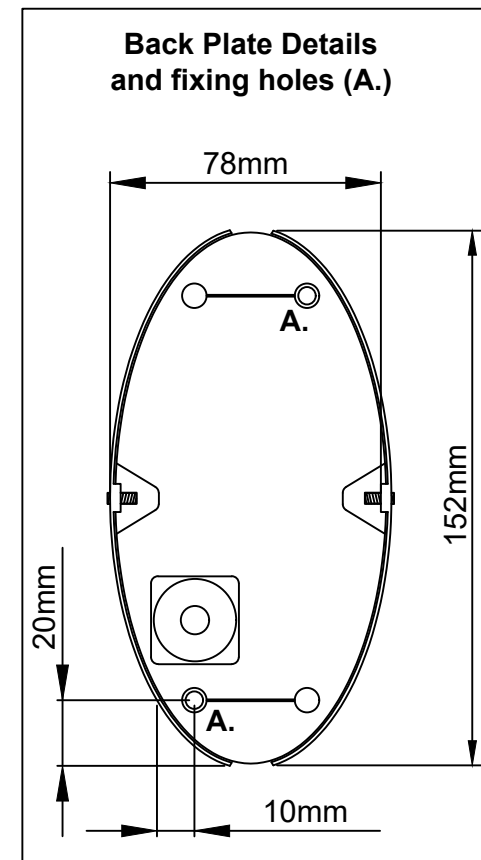
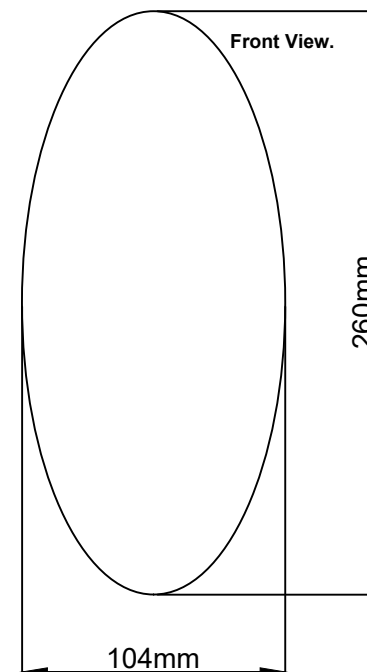
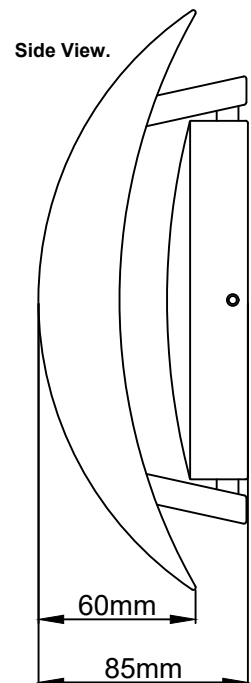

Top View.

45 Deg Max 45 Deg Max

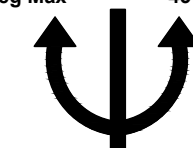

90 Deg Tilt in 15 Deg Increments.



Fitting output details - 9W LED

Product Code	Lumen output & CRI Details		
	3000K		
KSR1922	425lm	84	Class I

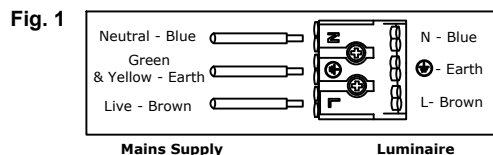

This product contains a light source of energy efficiency class G
The Control Gear in this product can be replaced by a professional.