



Avelino Wall & Bollard Range

Exterior Wall / Floor Lighting



Data Sheet

Product Information

The KSR **Family of Avelino Bollards** and matching **Wall Light** Range offer contemporary outdoor lighting solutions designed to enhance the ambiance and functionality of outdoor spaces. These fixtures combine sleek aesthetics with robust construction to provide durable and stylish lighting options.

The Avelino Bollards are available in two height options, **350mm and 650mm**, allowing flexibility in design and ensuring suitability for various domestic installation requirements and preferences. The **matching Wall Light** complements the bollards, offering consistent design elements for cohesive outdoor lighting schemes. They can be installed on walls, pillars, or other vertical surfaces to provide additional illumination and accentuate architectural features.

Product Features

- 3-year warranty
- Class I
- IP54
- 9W LED
- 3000K
- 335 Lumens
- CRI: Ra85
- 270° emitting angle
- 2 Bollard Heights 350mm & 650mm
- Matching Wall Light Available
- Cast Aluminium
- L70-40,000hrs

KSR1924



Product Specification

Product Code	Product Description	Wattage (W)	CCT (K)	Lumens (lm)	CRI (Ra)	Energy Efficiency Class 2021	Protection Class
KSR1924	Avelino 9W 3000K LED IP54 Wall Bollard Light Anthracite	9W	3000	335	85	G	I
KSR1925	Avelino 9W 3000K LED IP54 350mm Bollard Light Anthracite	9W	3000	335	85	G	I
KSR1926	Avelino 9W 3000K LED IP54 650mm Bollard Light Anthracite	9W	3000	335	85	G	I

Nominal voltage	100~240VAC
Operating frequency	50/60Hz
Circuit Wattage	11W
Circuit Current	0.06A
Driver mA Rating	TBC
PFC	0.8
In Rush Current	TBC
Ambient temperature range	0°C to +35°C
IP rating	54

Construction

Body: Cast Aluminium
Lens: Polycarbonate

Product Dimensions

KSR1924

Front View.

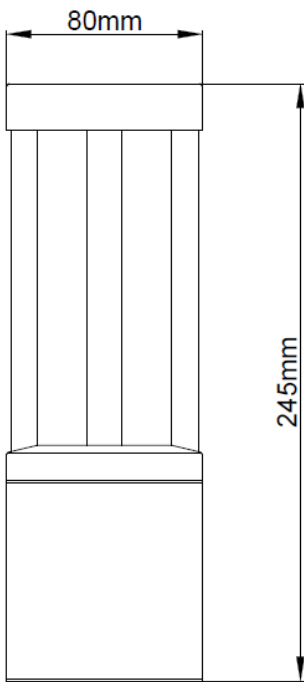

Side View.

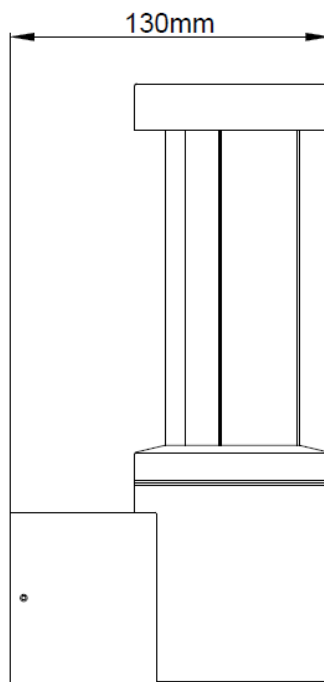

Back plate
Details.

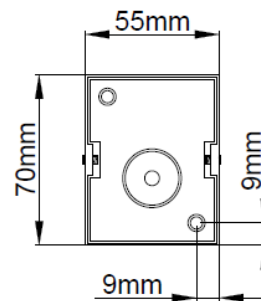

KSR1925

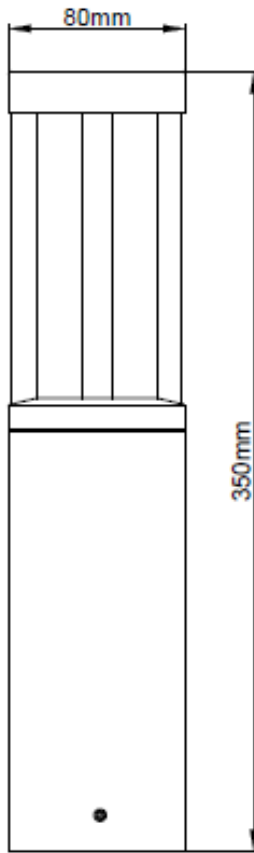

KSR1926

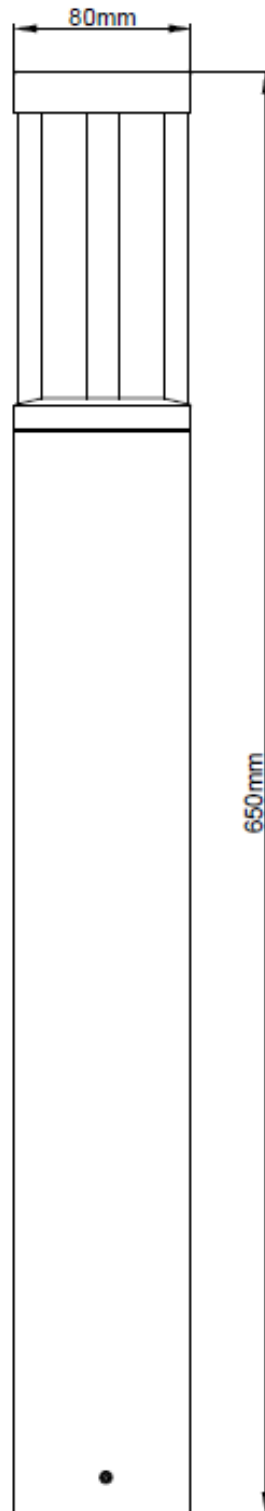

Base Fixing Details for KSR1925 & KSR1926.

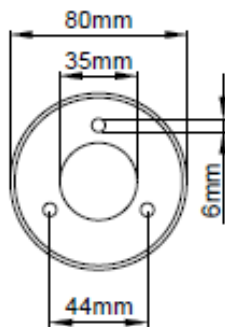

KSR Lighting is constantly developing and improving its products. For this reason, all product descriptions in this data sheet are intended as a general guide, and KSR may change specifications from time to time in the interest of product development, without prior notification or public announcement. All descriptions in this data sheet present only general particulars of the goods to which they refer and shall not form part of any contract. Data in this guide has been obtained in controlled experimental conditions. However, KSR Lighting cannot accept any liability arising from the reliance on such data to the extent permitted.